

RINA

Royal Institution of Naval Architects



**SHIPBUILDING
ICCAS**
Trieste • 2011

Sponsored by:

AVEVA

SHIPCONSTRUCTOR
SOFTWARE INC.

PTC

SIEMENS

**DASSAULT
SYSTEMES**

**SENER
FORAN 70**

BETA
CAE Systems SA

INTERGRAPH

**NUPAS
CADMATIC**

VIRTALIS
MAKE VIRTUAL A REALITY

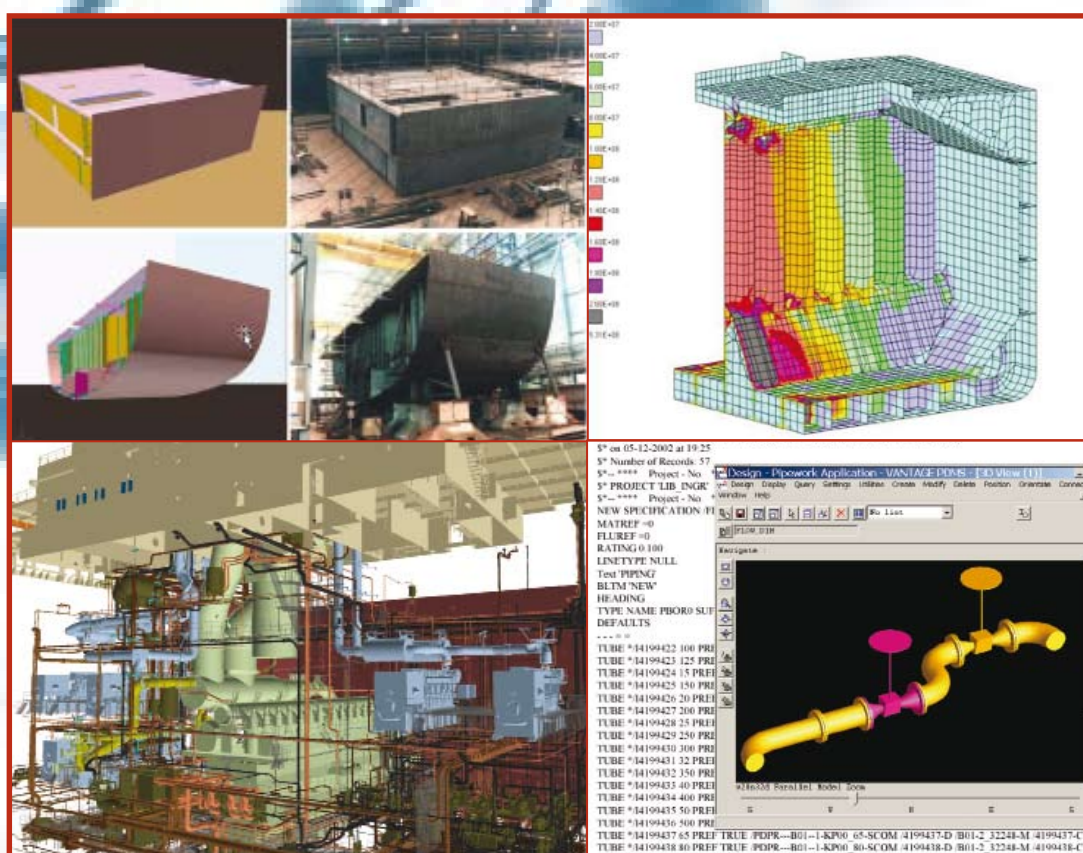

**THE INTERNATIONAL CONFERENCE
ON COMPUTER APPLICATIONS IN
SHIPBUILDING (ICCAS 2011)**

**20 - 22 SEPTEMBER 2011
TRIESTE, ITALY**

www.rina.org.uk/ICCAS2011

ICCAS 2011 • ICCAS 2011 • ICCAS 2011 •

ICCAS 2011 will be the 15th International Conference on Computer Applications in Shipbuilding. The 2011 conference will be held in Trieste, Italy on 20-22 September 2011.

The conference will review operational experience from existing computer applications in the design and build of ships and offshore structures. It will also examine the advances in Information Technology which have contributed to increased productivity in both shipbuilding and maritime operations; including increasing co-operative working between shipyards, marine equipment and system manufacturers, engineering partners and shipping companies.

The conference will attract a large international audience and provide a forum and means of professional development for all parties interested in computer applications in shipbuilding.

Venue

The conference will be held at the Hotel Savoia in Trieste, a magnificent seafront hotel with views over the Gulf and the historic Castello di Miramare. Located in the heart of the city, the Savoia Excelsior Palace exudes grand hotel charm through numerous prestigious details and exquisite food.

Address:
STARHOTELS SAVOIA EXCELSIOR PALACE
Riva del Mandracchio, 4
34124 Trieste
Telephone: +39 040 77941
www.starhotels.com



Deadlines and Key Dates

Deadline for submission of papers (Authors)	22 July 2011
Early Registration discount before	20 August 2011
Pre-registration (15.00 - 19.30)	19 September 2011
ICCAS 2011	20- 22 September 2011

Conference Dinner

20th September, kindly sponsored by Aveva.

Shipyard Visit

23rd September: Optional visit to Fincantieri's MONFALCONE SHIPYARD, transport provided. If you would like to attend the shipyard visit, please complete the tick box on the back cover when registering. We require a list of persons in advance so that security clearance can be obtained.

Language

The Language for the ICCAS 2011 conference is English

Sponsorship & Exhibition

This conference provides an excellent opportunity to increase your organisations profile and to network with a highly focused audience. A number of cost effective sponsorship options are available, including various conference sponsorship packages, exhibition space and literature distribution. If you are interested in promotional opportunities, please contact the Conference Organiser to discuss your individual requirements.

International Programme Committee:

Name	Company/Organisation	Country
Kaj Johansson	Aveva	Sweden
Cheng Qinghe	Hudong-zhonghua Shipbuilding	China
Torben Andersen	Odense Steel Shipyard	Denmark
Joachim Brodda	Balance Technology Consulting	Germany
Yoo-Sang Choo	National University of Singapore	Singapore
John Duncan	Ministry of Defence	UK
Soon-Hung Han	KAIST	Korea
Sung Geun Lee	DSME	Korea
Masahiro Sonda	Mitsubishi Heavy Industries	Japan
Richard Lee Storch	University of Washington	USA
Hiroyuki Yamato	University of Tokyo	Japan

source:historiccities.net



Further Information:

If you have any questions regarding this conference, please contact the RINA Conference department on:

Tel: +44 (0)20 7235 4622
Fax: +44 (0)20 7259 5912

Email: conference@rina.org.uk
Website: www.rina.org.uk/iccas2011

ICCAS 2011 • ICCAS 2011 • ICCAS 2011 •

Fast Robust Design Optimisation Methods Applied to Ship Hydrodynamics P. Geremia-Engys Srl, Italy and T. Schumacher, E. De Villiers-Engys Ltd, UK

Digital Manufacturing for Bending Ship Profile H. Yong, Li Peiyong, W. Chengfang and Z. Xuezhong - Wuhan University of Technology, Wuhan P.R. China

A Cost Effective Process For Simulation Based Design In Shipbuilding J. Martin - BAE Systems Engineering Fellow

Integrated Design and Multi-objective Optimization Approach to Ship Design A. Papanikolaou, G. N. Zaraphonitis, - National Technical University of Athens, S. Harries - FRIENDSHIP SYSTEMS GmbH and M. Wilken - Germannischer Lloyd AG.

Development of Fully Automatic Re-design System for Sub-Assembly Part Fabrication of Ship Blocks J.G. Park, M.S. Yi, Y.S. Ha, T.W. Jang - Welding Research Part, Samsung Heavy Industries

A Cost Effective Method Of Ship Block Distortion Control And Rectification Saeed Roshan Zamir, BAE Systems Australia

Computer Applications in Ship Recycling K Sivaprasad, S Jayaram and C G Nandakumar - Cochin University of Science and Technology, India

Through Life Asset Management by Integrated Life Cycle Costing and Concurrent Engineering Walshe. J. H, Watson. D. A, Blake. J. I. R. and Nguyen. T. D. - RNLI

Doubly Curved Ship Hull Plate Forming by Reconfigurable Die with Square Press Head Hu Yong - School of Transportation, China

Customizing A Cad System To Chinese Shipbuilding Industry G. Liu and R. Pérez Fernández-Sener - Ingeniería y Sistemas

Lean Manufacturing in Shipbuilding with Monte Carlo Simulation D. Kolich - University of Rijeka, Croatia

Optimization of Ship Block Division Considering Information Uncertainty K. Varikkattu, K. Hamada, M. Kitamura - Hiroshima University, Japan

Improved Cost Estimating as a basis for Shiprepair Project Control G. Bruce - University of Newcastle upon Tyne

A Contribution to Scenario Based Ship Design R. Bronsart, J. Wagner - University of Rostock

Naval operations' assessment through HLA based simulations D. Tozzi - CETENA

This is a preliminary program, stating only the papers that have been accepted by the Committee.

A fully detailed program will be available shortly at the event's website: www.rina.org.uk/ICCAS2011

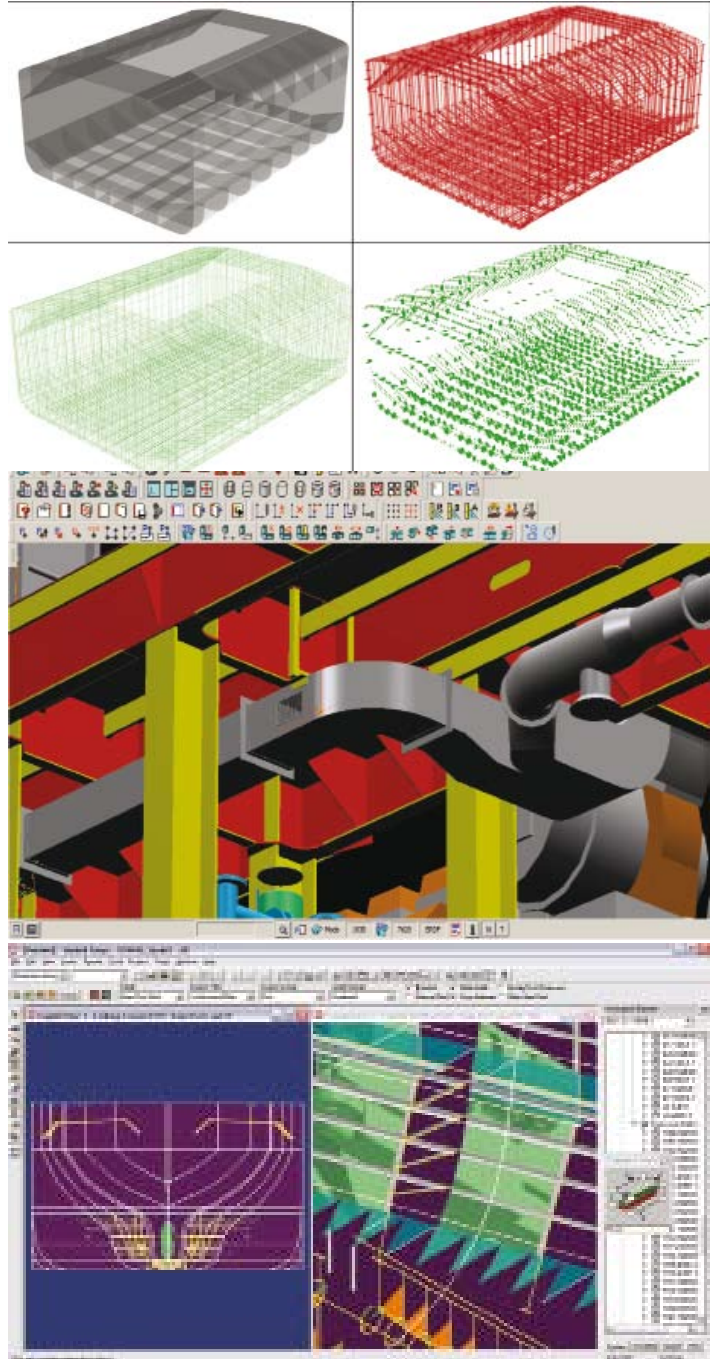

source:historiccities.net



ICCAS 2011 • ICCAS 2011 • ICCAS 2011 •

PAPERS ACCEPTED FOR ICCAS 2011 - TRIESTE, ITALY.

Dynamic Control of a Flexible Shipbuilding System under CONWIP Discipline F. Dong, M.van Oyen,D. Singer-University of Michigan, USA

Application of welding robot technology to shipbuilding
T. Shinohara- Universal Shipbuilding Corporation, Japan

An Automatic Piping Algorithm considering Elbows and Bends
Y. Ando - Kyushu University, Japan

Engine Room Pipeline Arrangement with Consideration of Equipments Operability Space by Genetic Algorism
Chung-Hung Lin- Nationanl Cheng Kung University

Total Design Optimization in Initial Design Stage based on Single 3D Ship Model T. Nakamatsu and K. Mizutani - Sanoyas Hishino Meisho Corporation and N. Mizutani-Napa Japan Ltd

Integrated Software-in-the-Loop Simulation of an Autonomously Acting Rescue Boat R. Bronsart, T. Buch, M. Haase, E. Ihde, N. Kornev, M. Kurowski, B. Lampe - University of Rostock

Simulation Driven Structural Design in Ship Building
A. Dodkins - BAE Systems

Efficient Integration of 3D Design with Engineering at the Early Design Stages I.Kuutti, N.Mizutani, H.S. Kim - Napa Ltd

Automatic Generation Of Fabrication Drawings BOM Using A Ship-Building CAD System A. Olmos - Navantia, Spain

The Electrical Design In A Highly Demanding Environment
A. Olmos, A. Valderrama - Navantia, Spain

A Effective Approach To Develop Integrated CAD, ERP And MES
Lin Cheng-Kuan- CSBC Corporation, TAIWAN

Development of “Block Lifting Simulation System” with Ship 3D-CAD Model Y.Miura - Universal Shipbuilding Corporation, Japan

Development of a Lot Formation System for a Flow Shop Layout Line in Shipbuilding K. Fukumoto, Y.Saitoh, R.Itoh, H.Wakita, J.Matsuno -Kawasaki Heavy Industries, Ltd.

High Precision Basic Design K.Hirai - Oshima Shipbuilding Co., Ltd

How can the most efficient design recourses from all over the world be easily utilized? M. Juntunen - Cadmatic Oy

Optimization of Torch Movements of Marking Using Ant Colony Method H. Kunikubo - IHI Marine United Inc.

Innover design platform; applied on naval ship design A. Bons - Maritime Research Institute Netherlands (MARIN)

Quality Improvement of Hull and Outfitting Designs Using 3D Model Reviews D.S. Baguio, Jr -Dash Engineering Philippines, Inc.

Application Of 3D CAD System As The Design Tool Takakazu Nakamori - Namura shipbuilding Co., Ltd, Japan

A New System Structure To Improve Documentation Processes Tender Phase E.Moredo and P. de Vos - Delft University of Technology and M.. Krikke - Scheepsbouw Nederland

Development of the Algorithm for Accuracy Evaluation System for Curved Shell Plates by Laser Scanner N.Nakagaki, A.Sugawara -Sumitomo Heavy Industries Marine&Engineering Co.Ltd.and K.Hiekata, H.Yamato,M.Enomoto and K.Takahashi - The Univesity of Tokyo

3D Model Based User-Friendly & Practical Application For Creating Stability Documents Supporting Statutory Rules
M.Kidogawa, T.Takamoto - Nippon Kaiji Kyokai (ClassNK) and T. Masui, J.Furustam - Napa Ltd

A Neutral XML Schema for Basic Design Stage Interface to Class Societies M. Polini - Intergraph Corp

Applying Agile Methodologies to Marine Implementation Projects
P. McFadden, S. Yamauchi - Intergraph Corporation

The True Benefits of 3D Design J. Baumer - Intergraph Corporation and Y.G. Kim - Samsung Heavy Industries

Integrated Development Environment in Shipbuilding Computer Systems A.Benayas and A.Cebollero - Sener Ingeniería y Sistemas S.A., Spain

Communication Processes In Shipbuilding Based On Intelligent 3D PDF Documents G.Willmes - PROSTEP AG, Germany

Advanced CAD - PLM Integration in a Naval Shipbuilding Environment F.Alonso and C.Gonzalez - SENER Ingeniería y Sistemas S.A., Spain

Improving assembly planning simulation with the use of Virtual Reality in the Maritime Industry
A.Friedewald - Technische Univerität Hamburg

cPLM vs. PLM (Capital Project vs. Product)
M.Veldhuizen - Marine Solutions

Tank Inspection By Cost Effective Rail Based Robots
L.Christensen,J.Lemburg,F. Kirchner - DFKI, N.Fischer,R.Ahlers - BALance TC,G.Psarros - DNV and L.E.Etzold - Meyer Werft

Product Lifecycle Management in the Shipbuilding and Shipping Industries C. Cabos - Germanischer Lloyd

Prudent Platform for Multidisciplinary Ship Design Exploration, Analysis and Optimisation R. Puisa and K.Mohamed - University of Strathclyde

The Use of a Fuzzy Logic Set-Based Design Tool to Evaluate Varying Complexities of Late-Stage Design Changes

T. A. McKenney - University of Michigan

Practical Implementation of the Most Advanced Steel Outfitting CAD System

B.C. Min. - Samsung Heavy Industries

Intelligent Ship Arrangements: Reseeding Scheme Development and Effectiveness

M.C. Parker, D. J. Singer, A.S. Daniels - University of Michigan

Lifecycle Decision-making under Uncertain Environmental Policy using Nonstationary Markov Decision Processes

N. Niese and D.J. Singer - University of Michigan

Business Integration Between CAD/CAM And ERP Systems In Shipbuilding Industry

Y Li Rong and Soonhung Han - KAIST

Automatic Designing System for Piping and Instruments Arrangement including Branches of Pipes

H. Kimura - Kyushu University, Japan

The Study On Ship Compartments Arrangement Optimization With Knowledge-Based Systems

B.Y. Chung - Pusan National University

New Approach to Design Transition in Korean Production Environment

D.J. Lee - Sener Korea and A. Cebollero - Sener Ingeniería y Sistemas S.A., Spain

Cell-based Discrete Event and Discrete Time Simulation for Advanced Evacuation Analysis considering Passenger Behavior in an Emergency of Passenger Ship

S. Ha, K.P. Park, N. Ku, K.Y. Lee - Seoul National University

Development of Layered DES (Discrete Event Simulation) framework for ship production simulation

B. Goo, H. Chung, C. Nan - KAIST

A Size Simulation of Automatic Storage and Retrieval System of a B1 Type Mobile Harbor

D. Kim, S. Han, H. Chung - KAIST

Decision Support System For Strategic Planning And Scheduling In Shipbuilding

K. Meijer, J. Pruyn - Technical University of Delft and J. Klooster - IHC Merwede

Using flight simulation to improve ship designs for helicopter operations

C.H. Kääriä, J.S. Forrest, I. Owen - University of Liverpool

An Approach to Accessing Product Data across the Shipbuilding Ecosystem

M. Pal - Shipbuilding, Siemens Industry Software

Ship Hull Synthesis Simulation System based on Integrated Seakeeping/Structural Analysis

I.E. Douglas - Rivers State University of Science and Technology, Nigeria

Development Of Interactive Tool For Paint Quantity Estimation Of Ship Structures

G. Sikic, M. Bisticic, D. Perkovic - USCS d.o.o.

Reverse Modelling Of Full Scale Ships: From 3d Digital Modelling To Performance Evaluation

E. Nocerino - Parthenope University of Naples

A CATIA® Ship-parametric Model for Isogeometric Hull Optimization with respect to Wave Resistance

P. A.I. Ginnis, C. Feurer, K.A. Belibassakis, P.D. Kaklis - NTUA and K.V. Kostas, Th.P. Gerothathis, C.G. Politis - TEI Athens, Greece

Gathering Spatial Knowledge from Virtual Reality Yacht Interiors

Isil Yildirim Ernis - Dokuz Eylul University, Turkey

CFD Meshing Tools and Their Integration into the Ship CAD Process

R. Bronsart, L. Kleinsorge - University of Rostock

Adoption Of 3D Hull Maintenance Software In Ship Operation

C. Cabos - Germanischer Lloyd

Advancements in the Teaching of Naval Architecture and Ship Design at Newcastle University Including Utilisation of AVEVA Initial Design 12.0

P.N.H. Wright - Newcastle University, K.W. Hutchinson - Babcock International and I. Applegrath - AVEVA Solutions Ltd.

An Integrated System for Ship Construction Projects Control

F. Pires Jr - Federal University of Rio de Janeiro

Developing and Using an Innovation and Engineering Maturity Model to Identify Competence Development

K. Jansson - Technical Research Centre of Finland, VTT

A Tool For The Assessment Of The Operability Of Ship Systems In Accordance With Solas Safe Return To Port Requirements

A. Douglas, L. Guarin, J. Logan - Safety at Sea Ltd and J. Cichowicz, University of Strathclyde, UK

Shipbuilding Contract Risk Monitoring and Management

L. F. Guimaraes - Petrobras

System Engineering For Shipbuilding: How PLM, Single Source Of Truth For Product Data, Will Improve Multidimensional Requirements Compliance

D. Bimal, P. Barbarin - PTC

The Role of Social Computing in Shipbuilding

D. Thomson - AVEVA

The Digital Shipyard Dream

S. Neuvéglise - AVEVA

Introducing an Integrated Schematics, Engineering and 3D Database Concept

S. Seçen and B. Aldridge - AVEVA

How Integrated Design Can Make Electrical Engineering A More Efficient Process

D. Gibson - AVEVA

Sliding Mode Controller For Salvaging Of Sunken Vessels

N. Srinil, Arun Kumar. D. - University of Strathclyde

A 3D Design System for Ship Electrical Fittings Arrangement

C.L. Su, W.L. Chung, L.W. Sie - National Kaohsiung Marine University and F.T. Lin, C.C. Lee, C.H. Liu, Y.C. Wu, C.W. Lin - CSBC Corporation, Kaohsiung, Taiwan

To register, simply complete all sections of this form and return it with your payment to:
The Conference Department, RINA, 10 Upper Belgrave Street,
London, SW1X 8BQ.
TEL: +44 (0)20 7201 2401
FAX: +44 (0)20 7259 5912
E-MAIL: conference@rina.org.uk

POSTCODE: _____

COUNTRY: _____

TELEPHONE: _____

FAX: _____

E-MAIL: _____

POSTCODE: _____

COUNTRY: _____

TELEPHONE: _____

FAX: _____

E-MAIL: _____

I enclose a cheque for:
(made payable to RINA) €

Please send me an invoice for : €

Bank Transfer details enclosed for: €

Please debit my credit card by:

A horizontal number line with 20 evenly spaced tick marks, labeled from 1 to 20.

Expiry Date: | | | | | | |

Signature: _____

Tel: +44 (0)20 7201 2401 Fax: +44 (0)20 7259 5912
E-Mail: conference@rina.org.uk www.rina.org.uk/events